



ON TRACK WITH RAIL ACCESS

The Largest rail car park in North America and best rail access in the region.

Dumas Texas is a centrally located community that boasts having one of the best Micropolitan economies in the nation. It is also home to the largest rail car park in North America with a capacity of over 10,000 rail cars and 147 miles of track. TXNW Railway interchanges with BNSF and offers over 550 acres of rail-served industrial development space. The newly designed Panhandle Logistics Park is perfectly situated to provide 24-7 operations for transload operations,

warehousing solutions, heavy industrial and cross-dock operations. Panhandle Logistics Park is capable of providing rail services and locations to companies big and small. The new Panhandle Logistics Center serves companies requiring loading and off-loading services for a minimal number of rail cars per month, while the Logistics Park provides large parcels of land with rail and highway access for companies requiring access for larger numbers of rail cars.

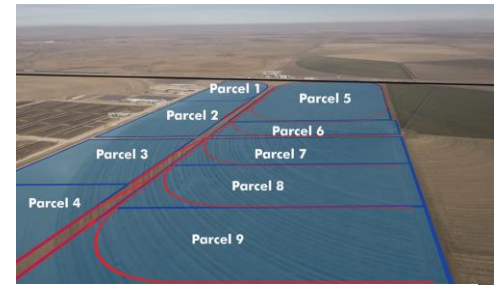

RAIL SERVED & RAIL READY

The Dumas Economic Development Corporation and the Texas North Western Railway (TXNW) located 12 miles north of Dumas partner to provide railcar storage, railcar and transload services to national, regional and local clients. Plus, the Dumas Business Park provides 265 acres to accommodate the needs of industrial, commercial or small businesses.

- Currently providing services to numerous international and local companies
- New rail car repair and refurbishment operation
- 24/7 operations
- Lay down yard space
- Highway access to US 287, a major 4-lane corridor
- No local regulations or impact fees
- Incentives available
- Transload space available for small businesses
- Top ranked short line services in the nation



FOR MORE INFORMATION CONTACT

Mike Running, Executive Director • Dumas Economic Development Corporation
 Office: 806-934-3332 • 900 North Dumas Avenue • P.O. Box 595 • Dumas, Texas 79029
www.dumasedc.org • www.dumasedge.com